





## Dock + Printer

Give your reader a home on your counter  
and print receipts

Quick start guide

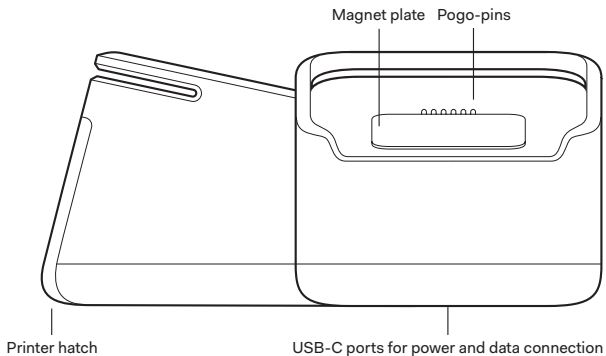
## Hardware overview



 **Dimensions** 67x83x114 (mm)

 **Paper roll size** 57x30 (mm)

 **Weight** 372g

 **Power adapter** 5V/2.4A

 **Wi-Fi** to connect to printer

 **USB-C** to connect to device

## Connecting the dock

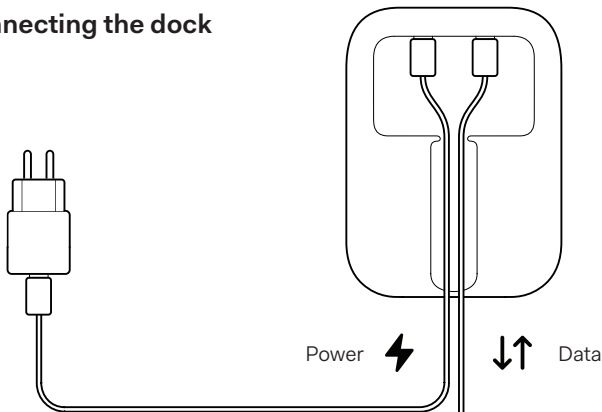

Connect the USB-C cable to the power port on the dock and plug it into a power socket using the power adapter.

Next, connect your mobile device via cable using the data port on the dock or via Bluetooth. If you connect via cable, the dock will also charge your device.

## Mounting to countertop

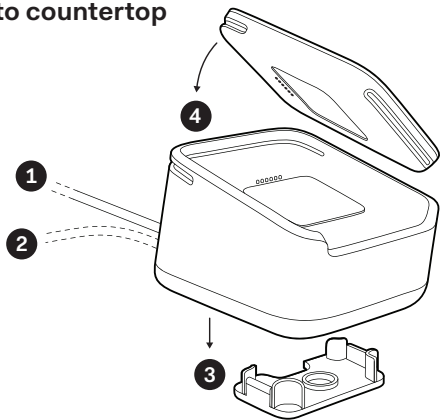

**1.** Check if all the cables are connected, as described on the previous page.

**2.** Fasten the snap plate in the desired position using the included adhesive strip or screw.

**3.** Place the dock on top of the plate and push down gently until the dock snaps into place.

**4.** Place the card reader in the dock.

## Replacing the paper roll

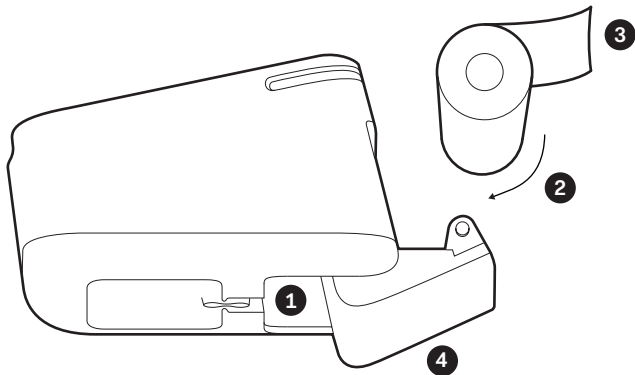

**1.** Press firmly on the bottom side of the paper hatch.

**2.** Place a new paper roll in the compartment.

**3.** Make sure the coated paper side is up and the paper aligns to the printing head.

**4.** Close the paper hatch and make sure it snaps into place.