





## Dock

Give your reader a home on your counter

Quick start guide

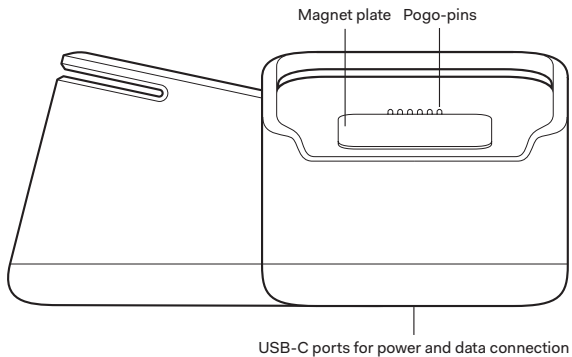
## Hardware overview



 **Dimensions** 67x83x114 (mm)

 **Power adapter** 5V/2.4A

 **Weight** 312g

 **USB-C** to connect to device

## Connecting the dock

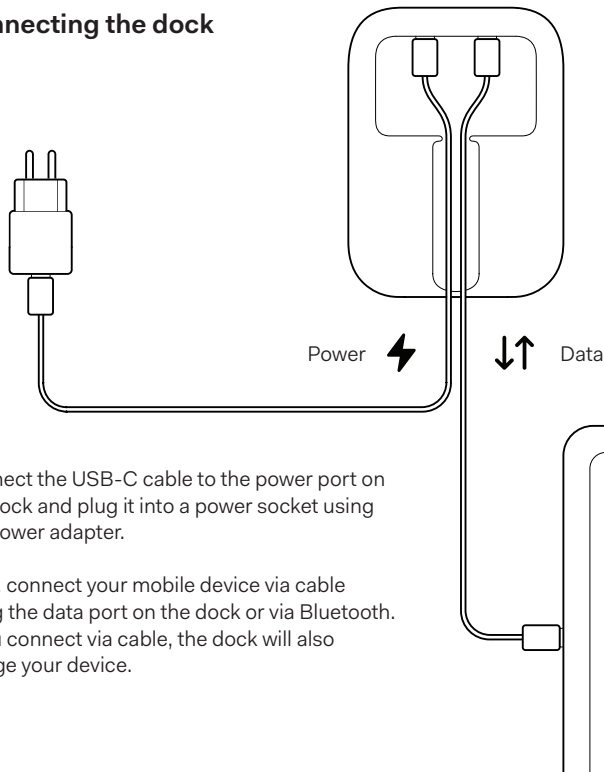

Connect the USB-C cable to the power port on the dock and plug it into a power socket using the power adapter.

Next, connect your mobile device via cable using the data port on the dock or via Bluetooth. If you connect via cable, the dock will also charge your device.

## Mounting to countertop

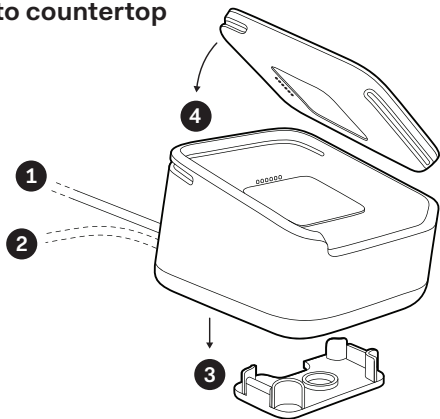

**1.** Check if all the cables are connected, as described on the previous page.

**2.** Fasten the snap plate in the desired position using the included adhesive strip or screw.

**3.** Place the dock on top of the plate and push down gently until the dock snaps into place.

**4.** Place the card reader in the dock.